

Betsy Dyer

From: Ryan Guild <Ryan.Guild@WasteConnections.com>
Sent: Tuesday, April 25, 2023 4:26 PM
To: Betsy Dyer
Subject: RE: City of DuPont Dumpster Location Approval - Avenue 55 DuPont 243 East / BCE# 18666
Attachments: Dumpster Enclosure Guide.pdf; SKM_80823042514040.pdf

Good afternoon Betsy, attached is the approval for the design as well as our enclosure requirements that we need for our trucks regarding the size and are needed to access the dumpsters. I am sure I have already shared with you before but in case I didn't, here it is.

Let me know if you have any questions.

Ryan Guild | Operations Manager | LeMay Pierce County
office: 253-300-6342 cell: 253-377-4044
email: RyanG@wcnx.org



From: Betsy Dyer <bdyer@barghausen.com>
Sent: Tuesday, April 25, 2023 2:00 PM
To: Ryan Guild <Ryan.Guild@WasteConnections.com>
Subject: City of DuPont Dumpster Location Approval - Avenue 55 DuPont 243 East / BCE#18666

Hi Ryan,

We are preparing a land use submittal to the City of DuPont for a two-building warehouse use project and will need your approval of the dumpster locations. This site is directly adjacent to the last project you helped me with. Attached is the architectural site plan showing the location of the two proposed dumpsters and a vicinity map for your reference. Please let me know if you need anything else to review.

Site address: 1700 Center Drive
Tax Parcel Number: 011926-6007

Thanks!

Betsy Dyer / Project Administrator

Office: 425-251-6222 | Direct: 425-656-7427
Barghausen Consulting Engineers, Inc.
18215 72nd Avenue South, Kent WA 98032

<http://secure-web.cisco.com/1BR2E0tg2Ar7LSTdOD6YYK->

[f3_P5UuXGnpUplv5DbxvuQTjIELWIDya2kteQqz_qHNs9QCxEMOyPKf4g-6DMBpGB_S-nT8LWU5l1qEK6RzB_--bfV1L9t7OSbpVyD5FrpehL1fJ82p1r66QdrUBTqP2ZKSIF5DZi6g07zSeT61ifC8gaR1YTPj2ns4BQ9aJWCyde_W1tt_kZHdhGOI_GSQ3yzYRExT5hW2QEeGfHwMS8MzzSOgeLUHQ1uA1_m_KeQL5_NLEXU82pBV3gcHSBemSINqRmAX63yPBYiyFojXO1](http://secure-web.cisco.com/1BR2E0tg2Ar7LSTdOD6YYK-f3_P5UuXGnpUplv5DbxvuQTjIELWIDya2kteQqz_qHNs9QCxEMOyPKf4g-6DMBpGB_S-nT8LWU5l1qEK6RzB_--bfV1L9t7OSbpVyD5FrpehL1fJ82p1r66QdrUBTqP2ZKSIF5DZi6g07zSeT61ifC8gaR1YTPj2ns4BQ9aJWCyde_W1tt_kZHdhGOI_GSQ3yzYRExT5hW2QEeGfHwMS8MzzSOgeLUHQ1uA1_m_KeQL5_NLEXU82pBV3gcHSBemSINqRmAX63yPBYiyFojXO1)

Dumpster Enclosure Guidelines

This guide will help you understand the size and approach area needed for service. Commercial vehicles are large and need appropriate space to work.

Dumpster Overview

Dumpster are serviced at least weekly and made of heavy steel with plastic lids. They are built to contain material and be lifted by a commercial vehicle. Regular wear is common and when damaged, we will repair them.

We have 2 types of dumpsters used to pick up waste and recycling (1) Front End Load - FEL & (2) Rear End Load - REL. Our operation team determines the type of container at the customers location based on safety conditions (i.e. overhead wires or access).

FEL Dumpsters are picked up with forks on the front of the truck and lifted overhead. FEL dumpsters range from size 1cy-6cy.

REL dumpsters are picked up at the rear of the truck and they require manual handling to hook up to the truck. REL dumpsters range from size 1cy-2cy.



Front End Load (FEL) – 6cy



Rear End Load (REL) – 2cy

Understanding the Truck

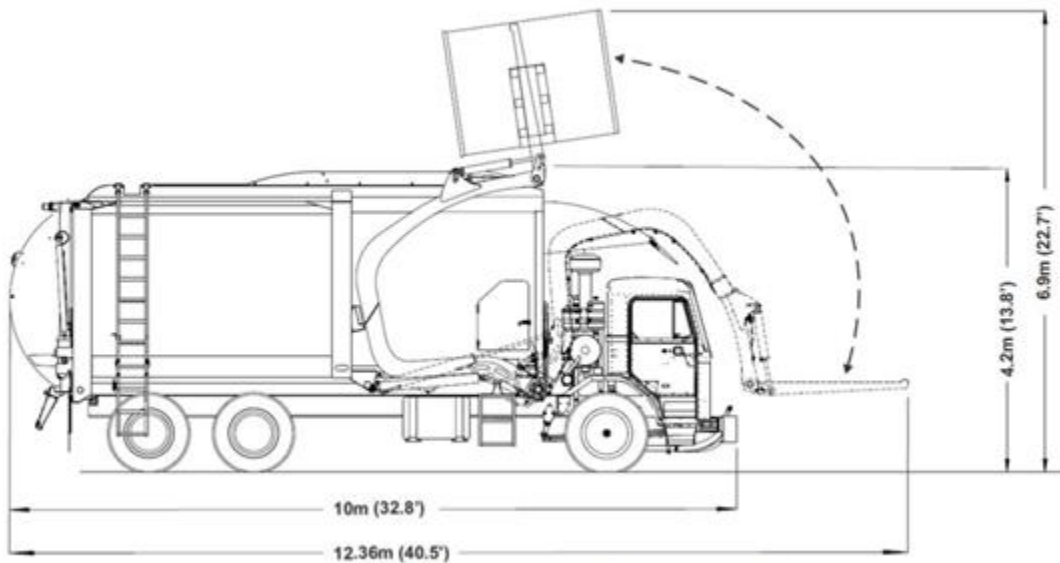

Front Loading Collection Truck (for Front End Bin)

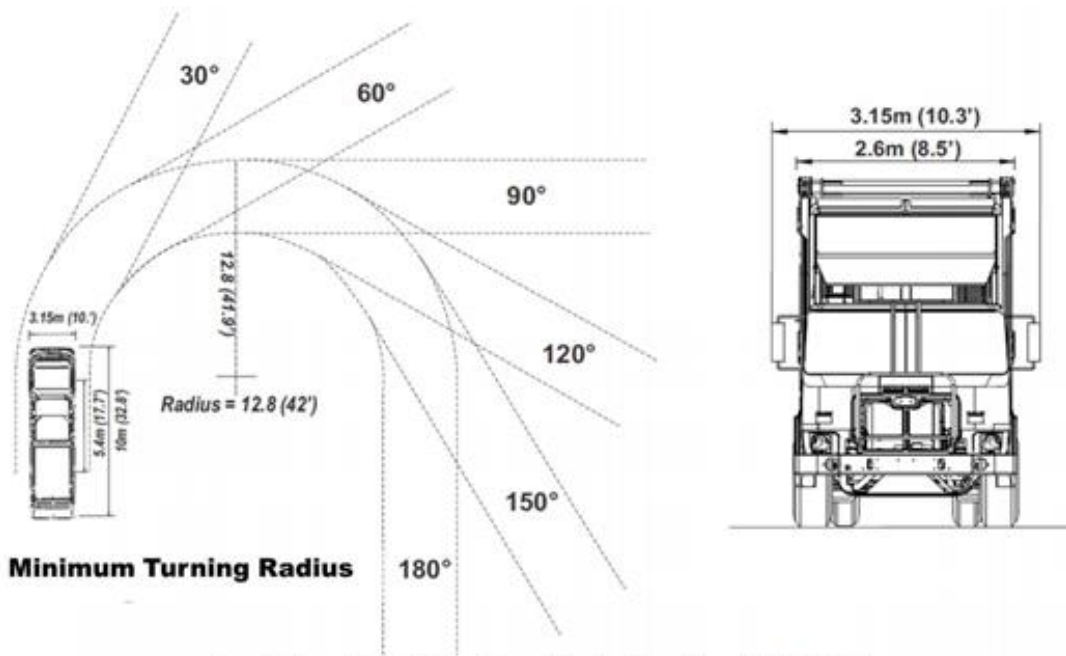

Front Loading Collection Truck (for Front End Bin)

Facts:

Commercial trucks are 33 ft long while driving and 40 ft long with lifting forks down in position to service dumpster

The truck needs a direct approach.

Understanding the Dumpster

6 YARD SLANT

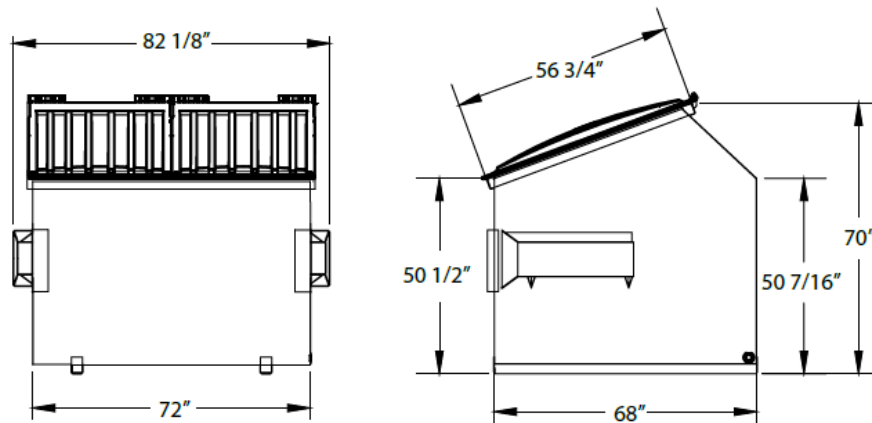

4 YARD SLANT NESTABLE

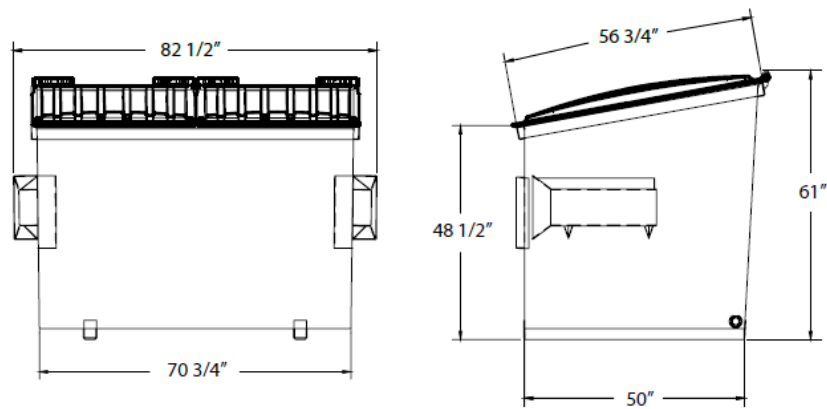

3 YARD SLANT NESTABLE

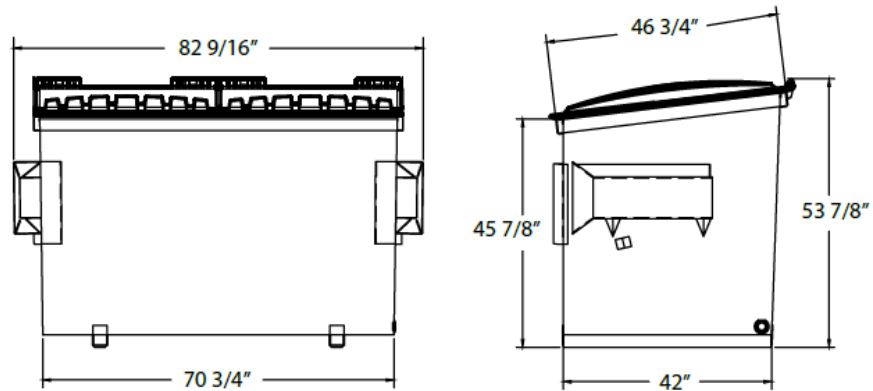

2 YARD SLANT NESTABLE

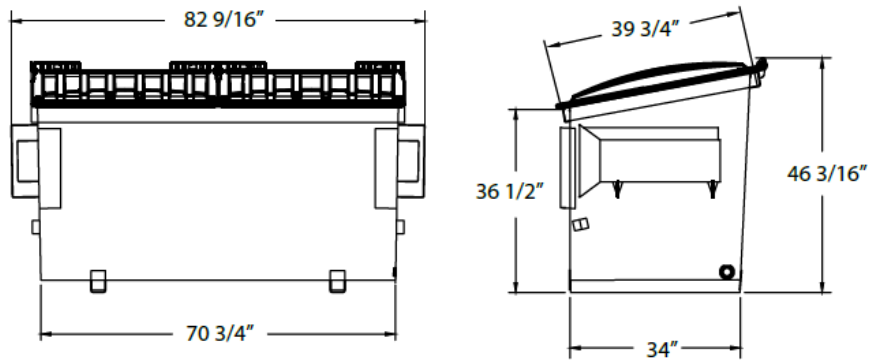

Understanding the Enclosure

All dumpsters are the same width, but their depth is different.

1. Width of truck and dumpster

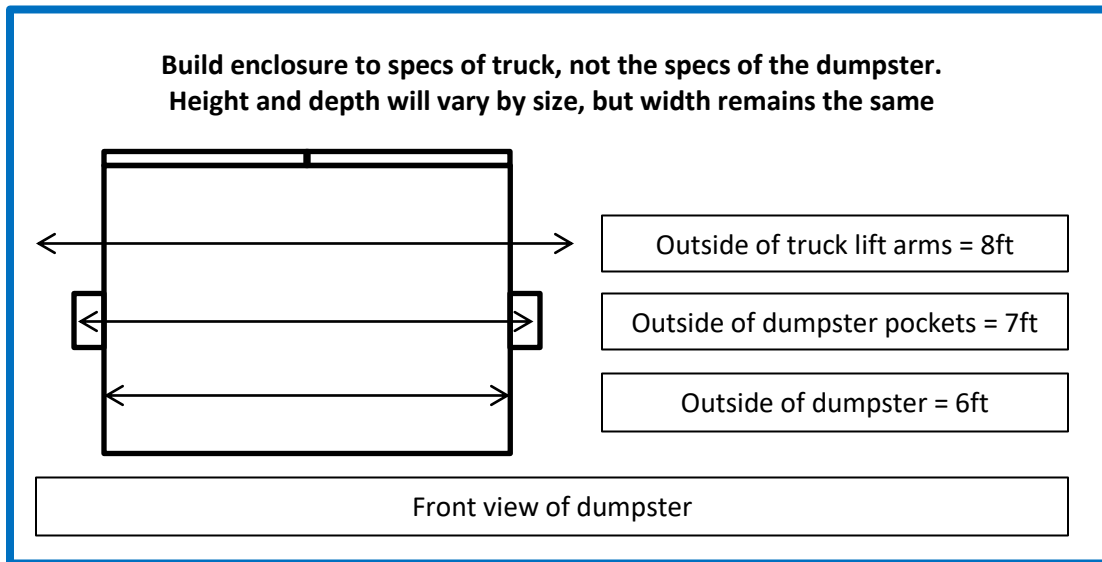

- Enclosure need to allow for 1 foot clearance of outside truck lift arms – min enclosure width is 10 feet.
- If you have 2 dumpster in the enclosure it needs to be 20 feet

2. Enclosure doors

Top view of enclosure

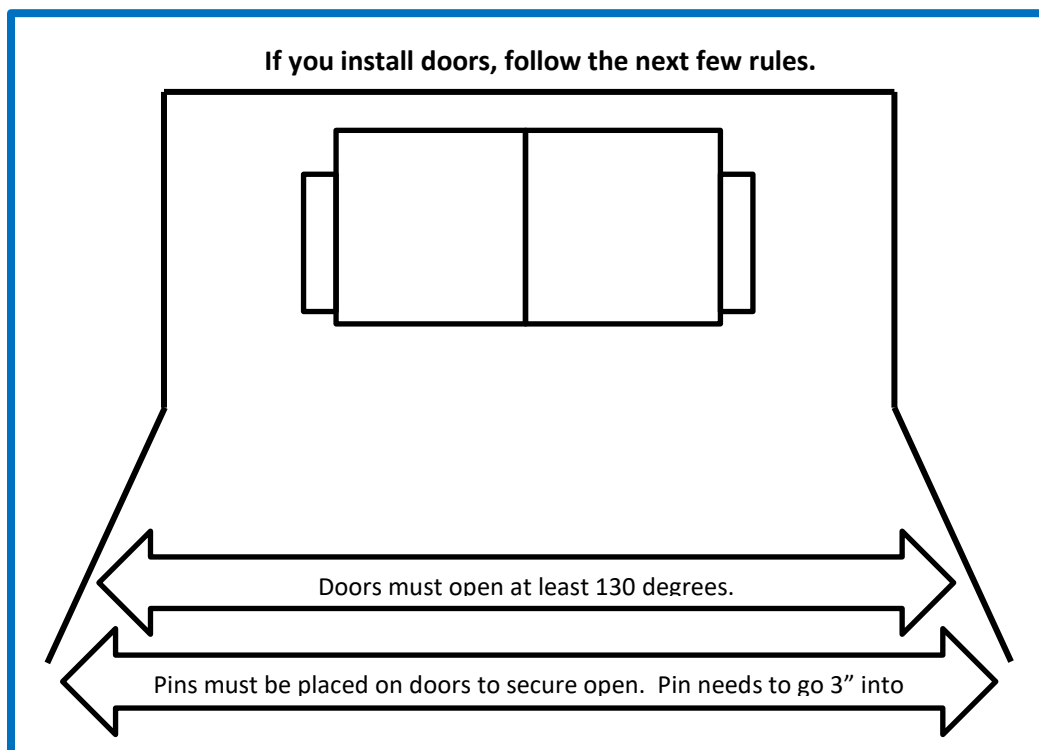

3. Dumpster lids

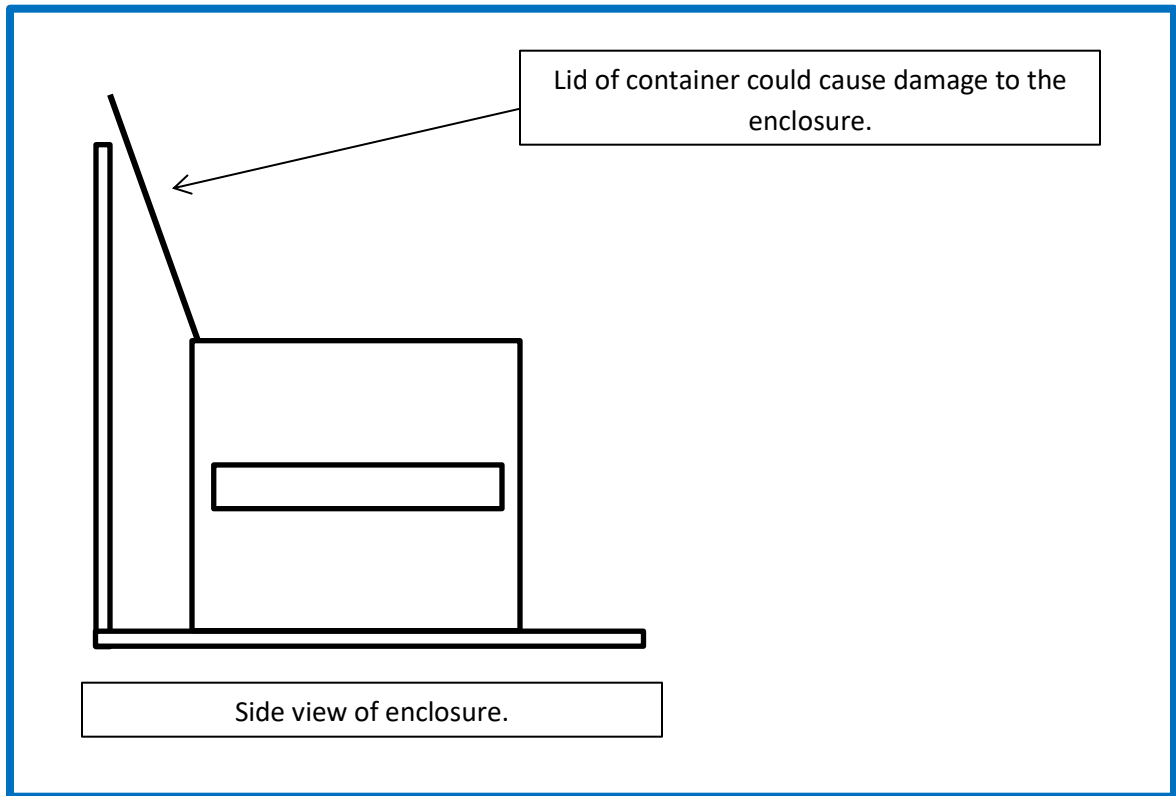

4. Enclosure Placement

- Truck needs direct access to enclosure – truck forks go straight into the pockets on the dumpster.
- Truck need overhead clearance to lift dumpster 25' into the air.